

A12 Chelmsford to A120 widening scheme

TR010060

2.10 DE-TRUNKING AND STOPPING UP PLANS PART 1

APFP Regulation 5(2)(k) & 5(2)(o)

Planning Act 2008

Infrastructure Planning (Applications: Prescribed
Forms and Procedure) Regulations 2009

Volume 2

August 2022

Infrastructure Planning

Planning Act 2008

A12 Chelmsford to A120 widening scheme Development Consent Order 202[]

DE-TRUNKING AND STOPPING UP PLANS PART 1

Regulation Reference:	Regulation 5(2)(k) & 5(2)(o)
Planning Inspectorate Scheme Reference	TR010060
Application Document Reference	TR010060/APP/2.10
Author:	A12 Project Team, National Highways

Version	Date	Status of Version
P01	August 2022	DCO Application

CONTENTS

1 Introduction1

1.1 General1

2 Schedule of plans included in this Application Document2

1 Introduction

1.1 General

- 1.1.1 National Highways (the Applicant) has submitted an application under section 37 of the Planning Act 2008 (the “2008 Act”) to the Secretary of State for Transport via the Planning Inspectorate (the Inspectorate) for an order to grant development consent for the A12 Chelmsford to A120 widening scheme (the proposed scheme).
- 1.1.2 The De-Trunking and Stopping Up Plans (‘these Plans’) have been prepared to accompany the application for a Development Consent Order (DCO), made by the Applicant to the Secretary of State for Transport via the Planning Inspectorate.
- 1.1.3 The proposed scheme comprises improvements to the A12 between junction 19 (Boreham interchange) and junction 25 (Marks Tey interchange), a distance of approximately 24km, or 15 miles. The proposed scheme involves widening the A12 to three lanes throughout (where it is not already three lanes) with a bypass between junctions 22 and 23 and a second bypass between junctions 24 and 25. It also includes safety improvements, including closing off existing private and local direct accesses onto the main carriageway, and providing alternative provision for walkers, cyclists and horse riders (WCH) to existing routes along the A12, which would be removed. A detailed description of the proposed scheme can be found in Chapter 2 of the Environmental Statement [TR010060/APP/6.1].
- 1.1.4 These Plans comprise part of the suite of Application Documents and are included in the DCO application in compliance with Regulations 5(2)(o) and 5(2)(k) of the Infrastructure Planning (Applications: Prescribed Forms and Procedure) Regulations 2009 (the 2009 Regulations), which require:
- ‘5(2)(o) any other plans, drawings and sections necessary to describe the proposals for which development consent is sought, showing details of design, external appearance, and the preferred layout of buildings or structures, drainage, surface water management, means of vehicular and pedestrian access, any car parking to be provided, and means of landscaping.’*
- ‘5(2)(k) where applicable, a plan identifying any new or altered means of access, stopping up streets or roads or any diversions, extinguishments or creation of rights of way or public rights of navigation.’*
- 1.1.5 These Plans are also being submitted under Regulation 5(4) of the 2009 Regulations which states:
- ‘Where a plan comprises three or more separate sheets a key plan must be provided showing the relationship between the different sheets.’*

- 1.1.6 As these Plans are part of the DCO application documentation, they should be read alongside (and are informed by) the other Application Documents, in particular, Schedule 3 of the draft DCO [TR010060/APP/3.1].

2 Schedule of plans included in this Application Document

Drawing number	Drawing title	Revision
PART 1		
HE51497-JAC-LDC-SCHW-DR-C-0700	De-Trunking and Stopping Up Plans Key Plan	P01
HE51497-JAC-LDC-SCHW-DR-C-0701	De-Trunking and Stopping Up Plans Sheet 01	P01
HE51497-JAC-LDC-SCHW-DR-C-0702	De-Trunking and Stopping Up Plans Sheet 02	P01
HE51497-JAC-LDC-SCHW-DR-C-0703	De-Trunking and Stopping Up Plans Sheet 03	P01
HE51497-JAC-LDC-SCHW-DR-C-0704	De-Trunking and Stopping Up Plans Sheet 04	P01
HE51497-JAC-LDC-SCHW-DR-C-0705	De-Trunking and Stopping Up Plans Sheet 05	P01
PART 2		
HE51497-JAC-LDC-SCHW-DR-C-0706	De-Trunking and Stopping Up Plans Sheet 06	P01
HE51497-JAC-LDC-SCHW-DR-C-0707	De-Trunking and Stopping Up Plans Sheet 07	P01
HE51497-JAC-LDC-SCHW-DR-C-0708	De-Trunking and Stopping Up Plans Sheet 08	P01
HE51497-JAC-LDC-SCHW-DR-C-0709	De-Trunking and Stopping Up Plans Sheet 09	P01
HE51497-JAC-LDC-SCHW-DR-C-0710	De-Trunking and Stopping Up Plans Sheet 10	P01

Drawing number	Drawing title	Revision
HE51497-JAC-LDC-SCHW-DR-C-0711	De-Trunking and Stopping Up Plans Sheet 11	P01
HE51497-JAC-LDC-SCHW-DR-C-0712	De-Trunking and Stopping Up Plans Sheet 12	P01
HE51497-JAC-LDC-SCHW-DR-C-0713	De-Trunking and Stopping Up Plans Sheet 13	P01
HE51497-JAC-LDC-SCHW-DR-C-0714	De-Trunking and Stopping Up Plans Sheet 14	P01
HE51497-JAC-LDC-SCHW-DR-C-0715	De-Trunking and Stopping Up Plans Sheet 15	P01
HE51497-JAC-LDC-SCHW-DR-C-0716	De-Trunking and Stopping Up Plans Sheet 16	P01
HE51497-JAC-LDC-SCHW-DR-C-0717	De-Trunking and Stopping Up Plans Sheet 17	P01
HE51497-JAC-LDC-SCHW-DR-C-0718	De-Trunking and Stopping Up Plans Sheet 18	P01
HE51497-JAC-LDC-SCHW-DR-C-0719	De-Trunking and Stopping Up Plans Sheet 19	P01
HE51497-JAC-LDC-SCHW-DR-C-0720	De-Trunking and Stopping Up Plans Sheet 20	P01
HE51497-JAC-LDC-SCHW-DR-C-0721	De-Trunking and Stopping Up Plans Sheet 21	P01

C:\working\jacobs_uk_highways_ssa\elnour\155545\HE551497-JAC-LDC-SCHW-DR-C-0700.dwg - 05/08/2022 07:33:55 - A1Frame - ElnourA

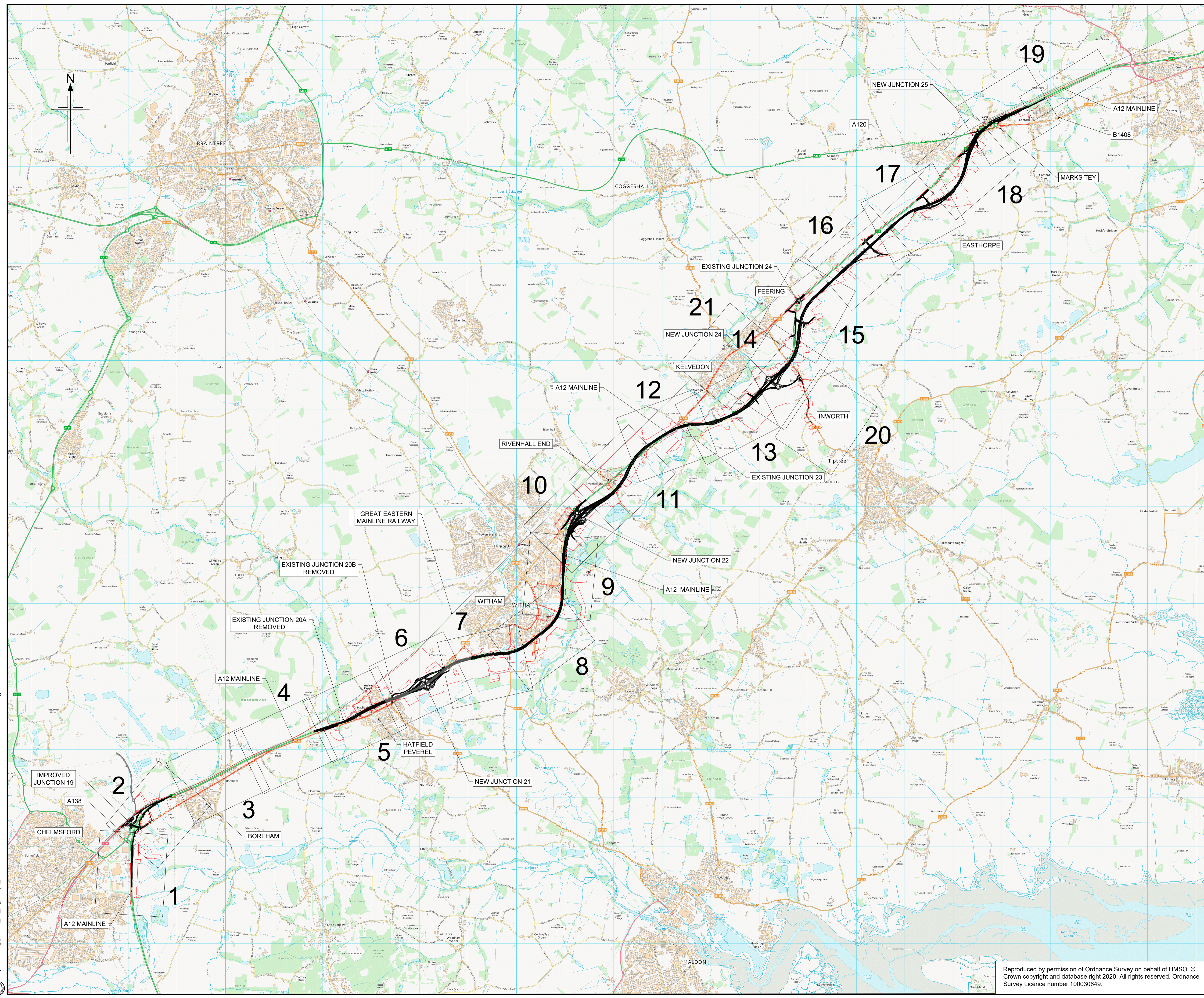

- NOTES**
1. ALL DIMENSIONS ARE IN METRES UNLESS OTHERWISE STATED.
 2. THIS PLAN SHOULD BE READ IN CONJUNCTION WITH OTHER PLAN APPLICATION DOCUMENTS IN PARTICULAR SCHEDULE 3 OF THE DEVELOPMENT CONSENT ORDER.

LEGEND

ORDER LIMITS

Rev	Rev. Date	Purpose of revision	Drawn	Checked	Rev'd	Apprv'd
P01	04/08/22	DCO APPLICATION	AE	CA	CA	DT

Development Consent Order Number: TR010060
 Development Consent Order Drawing Number: TR010060/APP/2.10



Client: national highways

Project: A12 CHELMSFORD TO A120 WIDENING SCHEME

Drawing title: DE-TRUNKING AND STOPPING UP KEY PLAN

Regulation	REGULATION 5(2)(k) & 5(2)(o)	
Purpose of issue	DCO APPLICATION	
State Code	Preliminary	Drawing status
Project Stage	PCF3	S4
Scale at A1 (841x594mm)	NTS	Rev
Jacobs No.	B36601D1	P01
Client no.	HE551497	

Drawing number: HE551497 - JAC - LDC - SCHW
 PIN: -DR- C -0700
 Originator: JAC
 Volume: -DR- C -0700
 Location: SCHW
 Type: -DR-
 Role: C
 Number: 0700

Reproduced by permission of Ordnance Survey on behalf of HMSO. © Crown copyright and database right 2020. All rights reserved. Ordnance Survey Licence number 100030649.

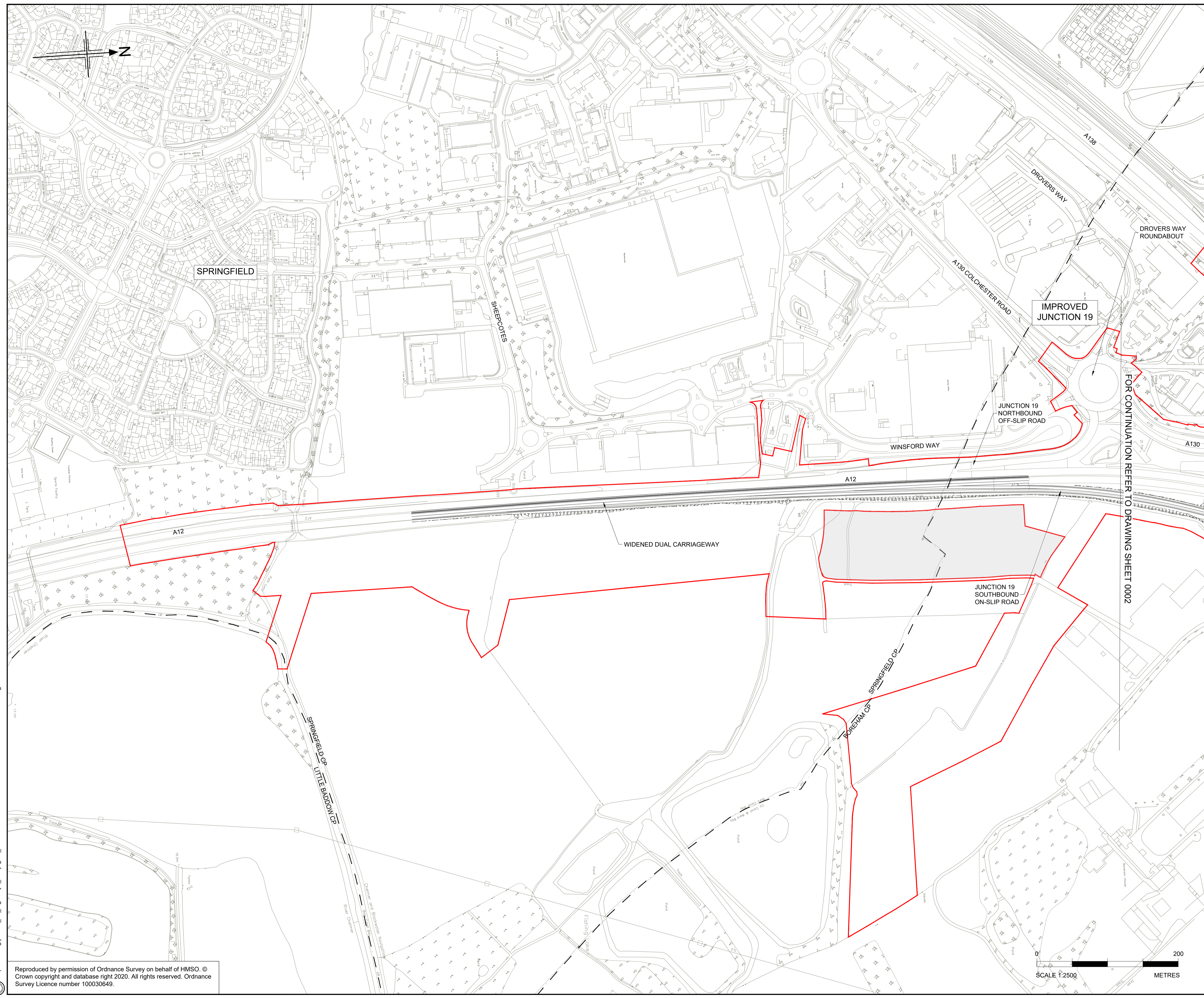

- NOTES**
1. ALL DIMENSIONS ARE IN METRES UNLESS OTHERWISE STATED.
 2. THE BASE MAPPING IS BASED ON ORDNANCE SURVEY (O/S) DATA.
 3. THIS PLAN SHOULD BE READ IN CONJUNCTION WITH OTHER APPLICATION DOCUMENTS.

- HIGHWAY TO BE DE-TRUNKED
- PARISH BOUNDARY
- ORDER LIMITS
- ADMINISTRATIVE BOUNDARY
- LAND NOT INCLUDED WITHIN ORDER LIMITS
- HIGHWAY TO BE STOPPED UP
- HIGHWAY TO BE DE-TRUNKED - REFERENCE LABEL
- HIGHWAY TO BE STOPPED UP - REFERENCE LABEL

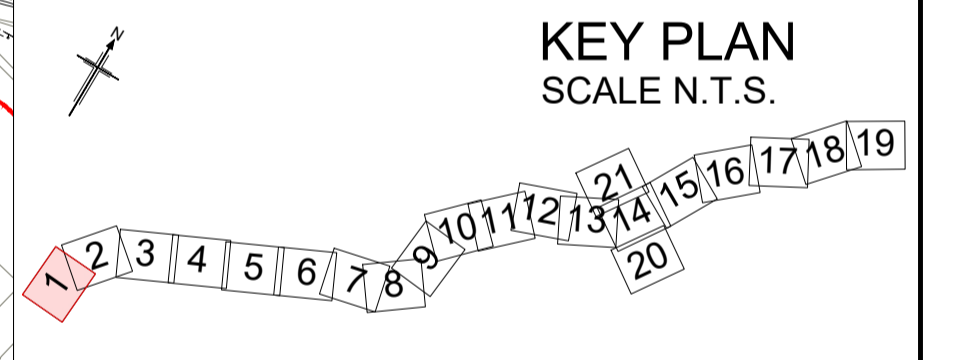

P01	01/08/22	DCO APPLICATION	ES	CA	CA	DT
Rev	Rev. Date	Purpose of revision	Drawn	Checked	Rev'd	Appr'd

Development Consent Order Number:	Development Consent Order Drawing Number:
TR010060	TR010060/APP/2.10



Project
A12 CHELMSFORD TO A120 WIDENING SCHEME

Drawing title
DE-TRUNKING AND STOPPING UP PLANS SHEET 01 OF 21

Regulation	REGULATION 5(2)(k) & 5(2)(o)	
Purpose of issue	DCO APPLICATION	
State Code	Preliminary	
Project Stage	PCF3	Drawing status
Scale at A1 (841x594mm)	1:2500	S4
Jacobs No.	B36601D1	Rev
Client no.	HE551497	P01

Drawing number
HE551497 - JAC - LDC - SCHW - DR - C - 0701

Originator
JAC

Volume
LDC

Location
SCHW





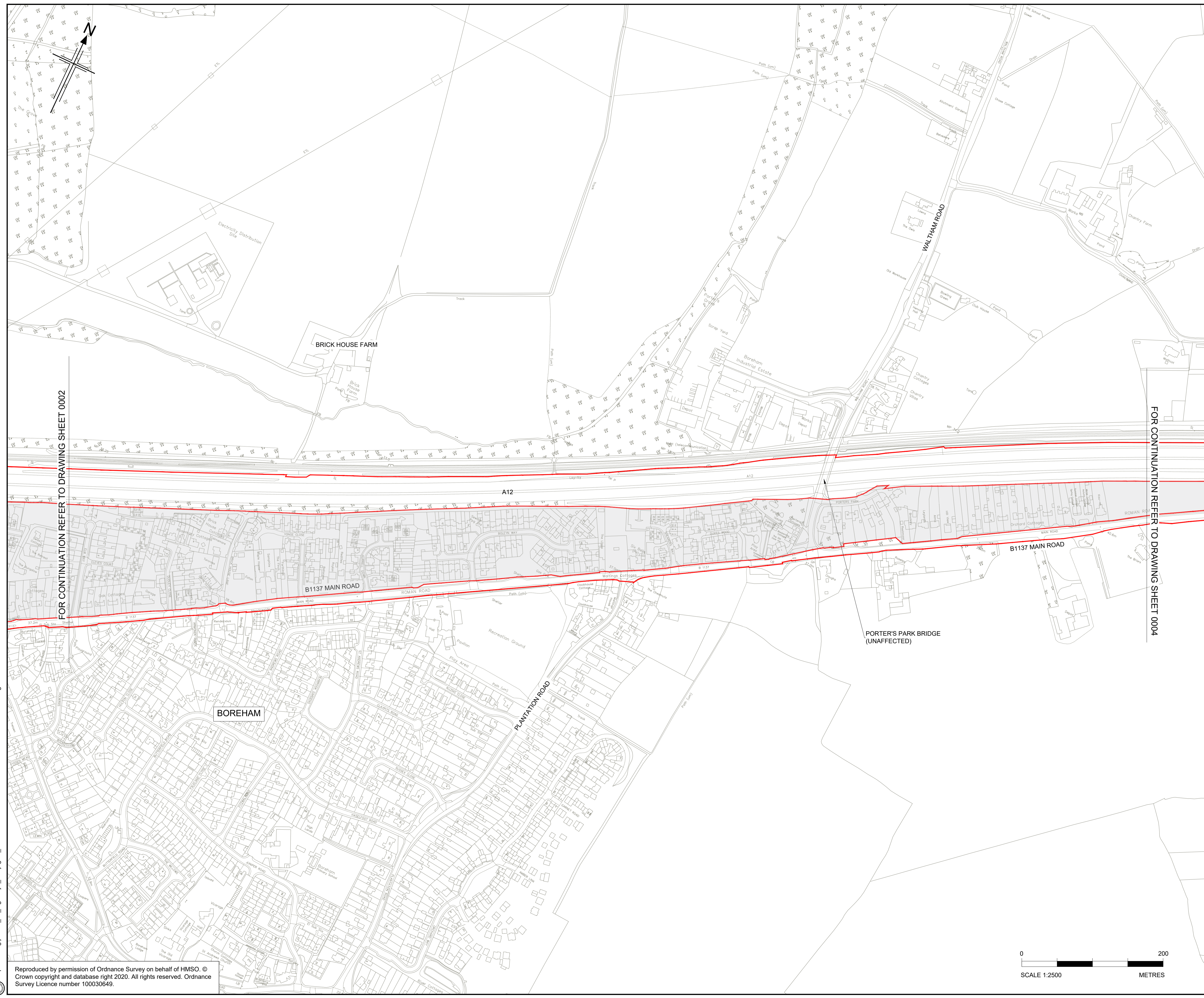

Type | Role | Number
-DR- C - 0701

C:\working\jacobs_uk_highways_ssa\legiml_had0155545\HE551497-LDC-LDC-SCHW-DR-C-0701.dwg - 8/2/2022 11:12:59 AM - A1Frame - HA

Reproduced by permission of Ordnance Survey on behalf of HMSO. © Crown copyright and database right 2020. All rights reserved. Ordnance Survey Licence number 100030649.

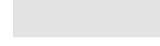

- NOTES**
1. ALL DIMENSIONS ARE IN METRES UNLESS OTHERWISE STATED.
 2. THE BASE MAPPING IS BASED ON ORDNANCE SURVEY (O/S) DATA.
 3. THIS PLAN SHOULD BE READ IN CONJUNCTION WITH OTHER APPLICATION DOCUMENTS.

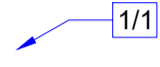
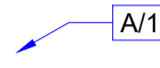
-  HIGHWAY TO BE DE-TRUNKED
-  PARISH BOUNDARY
-  ORDER LIMITS
-  ADMINISTRATIVE BOUNDARY
-  LAND NOT INCLUDED WITHIN ORDER LIMITS
-  HIGHWAY TO BE STOPPED UP
-  HIGHWAY TO BE DE-TRUNKED - REFERENCE LABEL
-  HIGHWAY TO BE STOPPED UP - REFERENCE LABEL

FOR CONTINUATION REFER TO DRAWING SHEET 0002

FOR CONTINUATION REFER TO DRAWING SHEET 0004

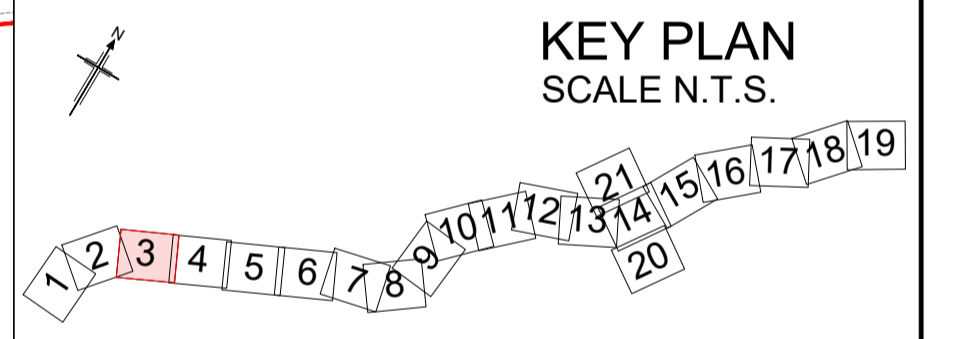

P01	01/08/22	DCO APPLICATION	ES	CA	CA	DT
Rev	Rev. Date	Purpose of revision	Drawn	Checked	Rev'd	Appr'd

Development Consent Order Number:	Development Consent Order Drawing Number:
TR010060	TR010060/APP/2.10



Project
A12 CHELMSFORD TO A120 WIDENING SCHEME

Drawing title
DE-TRUNKING AND STOPPING UP PLANS SHEET 03 OF 21





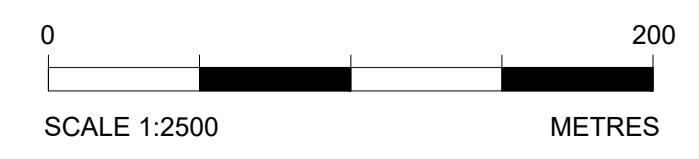

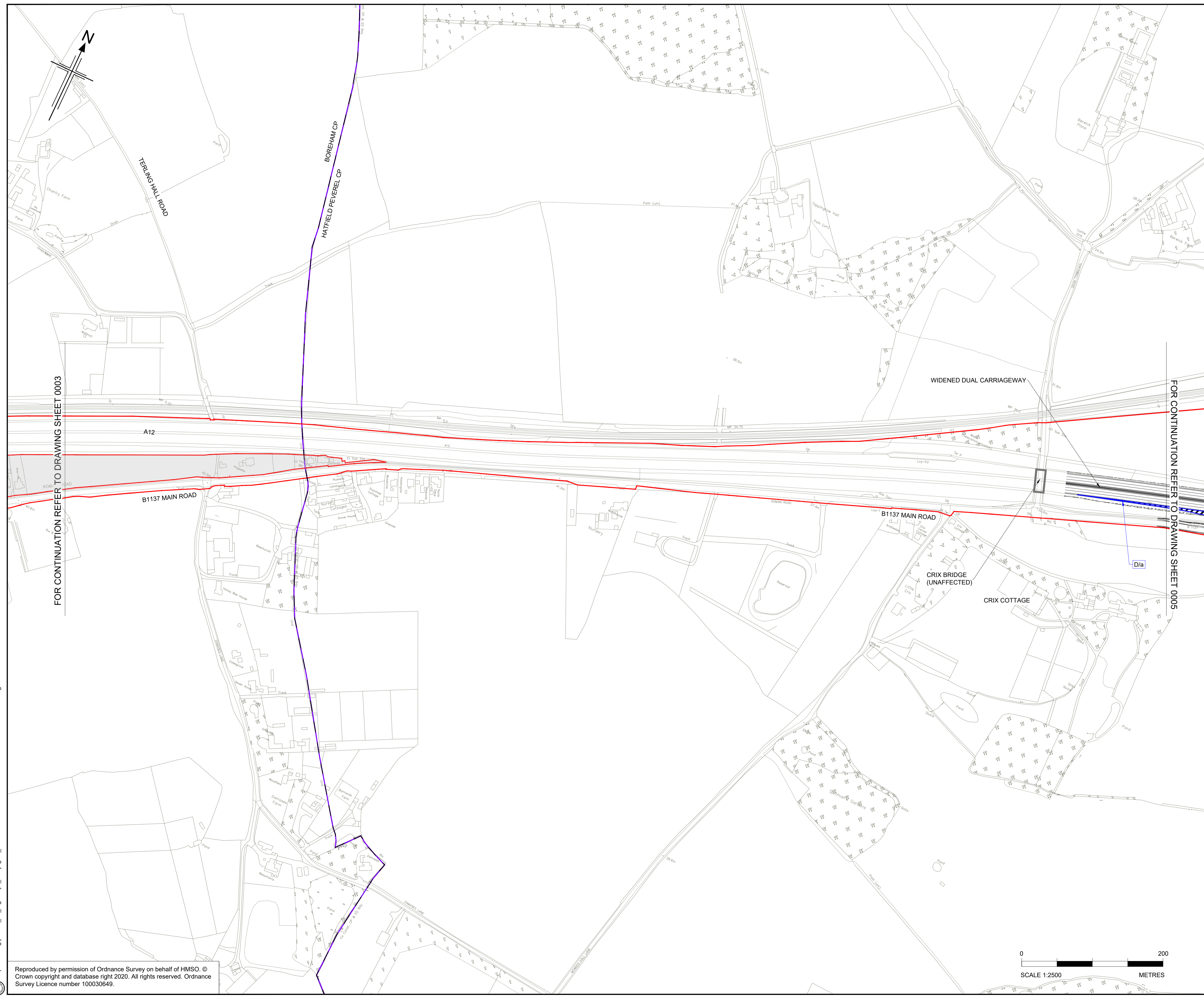

Regulation	REGULATION 5(2)(k) & 5(2)(o)	
Purpose of issue	DCO APPLICATION	
State Code	Preliminary	
Project Stage	PCF3	Drawing status
Scale at A1 (841x594mm)	1:2500	S4
Jacobs No.	B36601D1	Rev
Client no.	HE551497	P01

Drawing number	PIN	Originator	Volume
HE551497	JAC	LDC	-
Location	SCHW	Type	Role
		Number	
		-DR-	C-0703



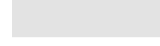

- NOTES**
1. ALL DIMENSIONS ARE IN METRES UNLESS OTHERWISE STATED.
 2. THE BASE MAPPING IS BASED ON ORDNANCE SURVEY (O/S) DATA.
 3. THIS PLAN SHOULD BE READ IN CONJUNCTION WITH OTHER APPLICATION DOCUMENTS.

-  HIGHWAY TO BE DE-TRUNKED
-  PARISH BOUNDARY
-  ORDER LIMITS
-  ADMINISTRATIVE BOUNDARY
-  LAND NOT INCLUDED WITHIN ORDER LIMITS
-  HIGHWAY TO BE STOPPED UP
-  HIGHWAY TO BE DE-TRUNKED - REFERENCE LABEL
-  HIGHWAY TO BE STOPPED UP - REFERENCE LABEL

FOR CONTINUATION REFER TO DRAWING SHEET 0003

FOR CONTINUATION REFER TO DRAWING SHEET 0005

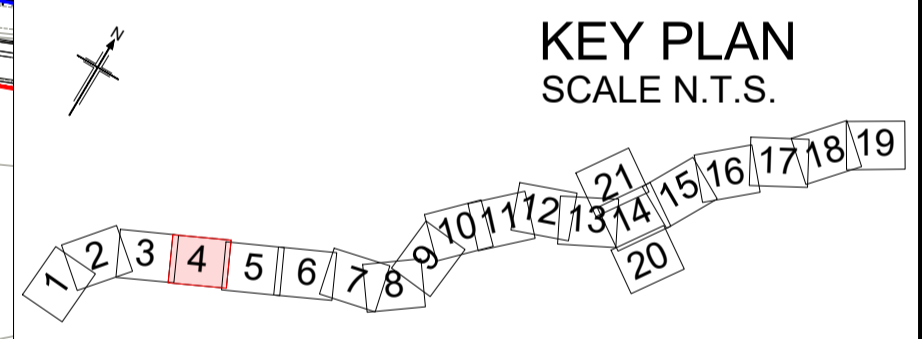

P01	02/08/22	DCO APPLICATION	AE	WD	CA	DT
Rev	Rev. Date	Purpose of revision	Drawn	Checked	Rev'd	Appr'd

Development Consent Order Number:	Development Consent Order Drawing Number:
TR010060	TR010060/APP/2.10



Project
A12 CHELMSFORD TO A120 WIDENING SCHEME

Drawing title
DE-TRUNKING AND STOPPING UP PLANS
SHEET 04 OF 21

Regulation	REGULATION 5(2)(k) & 5(2)(o)	
Purpose of issue	DCO APPLICATION	
State Code	Preliminary	Drawing status
Project Stage	PCF3	Rev
Scale at A1 (841x594mm)	1:2500	S4
Jacobs No.	B36601D1	Rev
Client no.	HE551497	P01

Drawing number	PIN	Originator	Volume
HE551497	JAC	LDC	
Location	Type	Role	Number
SCHW		DR	C 0704

